

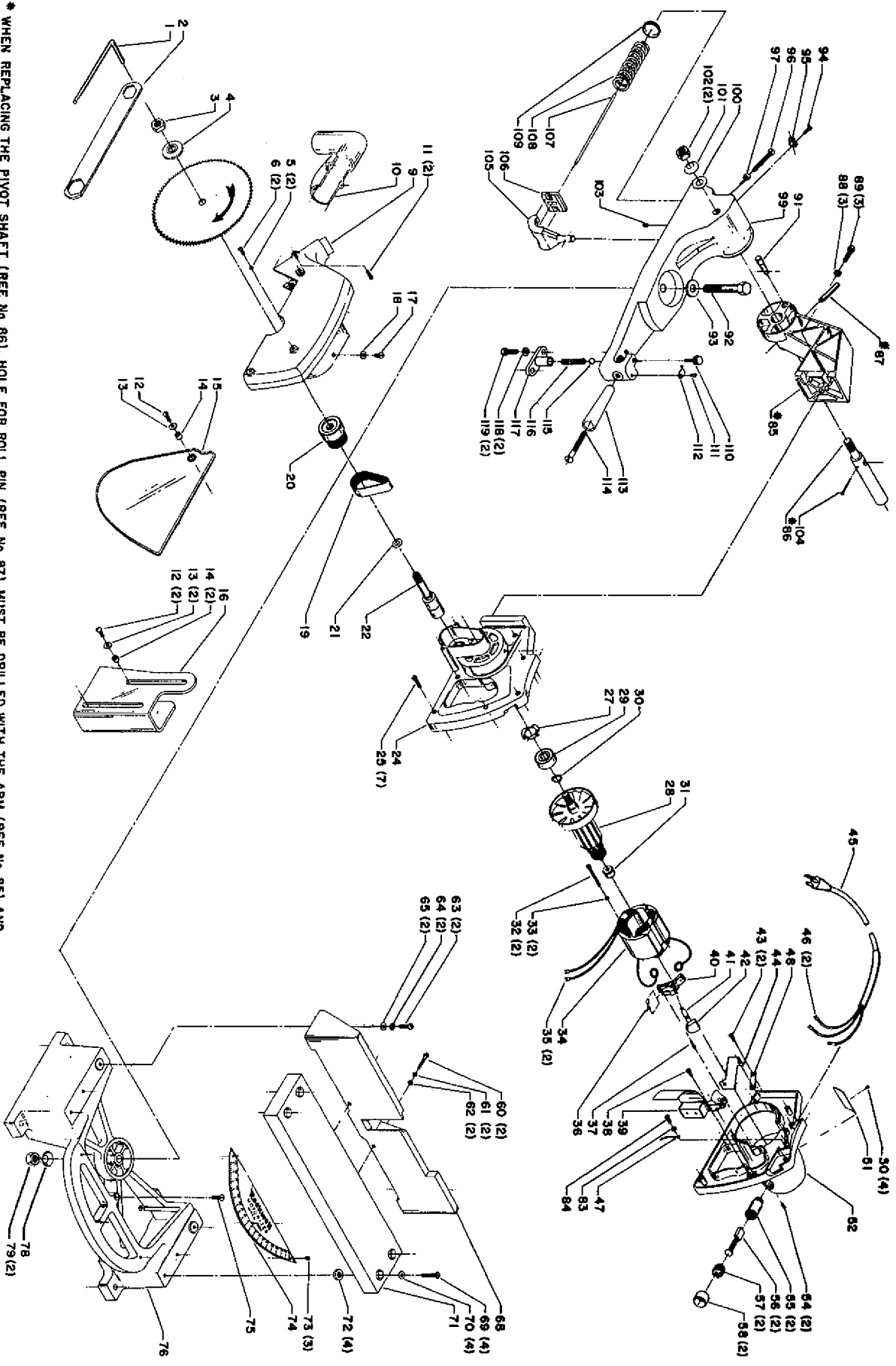

34-010 MOTORIZED MITER BOX (BEGINNING WITH SERIAL NO. FD-6575)

MB-1A
422-17-651-0002
Revised 1-1-85



Parts List for 34-010 Type 1 S/N FD-6575 & ABOVE

Item Number	Part Number	Description	Qty Required
1	955030202200	HEX WRENCH	1
2	000000-00	No Longer Available	1
3	902012018563	5/8-11 LH JAM-NUT	1
4	489170-00	FLANGE	1
5	904020101701	Use 904-02-010-1726	2
6	901061217381	SCREW	2
9	000000-00	No Longer Available	1
10	422170262001	CHUTE	1
11	680855	ALTVEND-DJ	2
11	901061617382	Use 1087576	1
12	901020100503	MACHINE SCREW	2
13	904010101614	STEEL WASHER	2
14	422171040001	SPACER	2
15	000000-00	No Longer Available	1
16	000000-00	No Longer Available	1
17	901030408015	CAP SCREW	1
18	904010101614	STEEL WASHER	1
19	000000-00	No Longer Available	1
20	000000-00	No Longer Available	1
21	904010122479	WASHER	1
22	000000-00	No Longer Available	1
24	000000-00	No Longer Available	1
25	000000-00	No Longer Available	1
27	928070107355	SPRING	1
29	920040205335	BEARING	1
30	904150120293	RING	4
31	920040916633	BEARING	1

COPYRIGHT© 2005. All Rights Reserved.

Parts list, pricing, and availability subject to change. Please visit www.dewaltservicenet.com for current parts information.

Parts List for 34-010 Type 1 S/N FD-6575 & ABOVE

Item Number	Part Number	Description	Qty Required
32	901020520716	SCREW	2
32	901020520716	SCREW	2
33	491958-00	LOCK WASHER	2
36	928030121753	SPRING	1
37	422170710002	PIN	1
38	901061217383	SCREW	1
39	691857	SWITCH-OFFON	1
40	000000-00	No Longer Available	1
41	842828	BRAKE LEVER	1
42	842827	BRAKE BUTTON	1
43	901061217383	SCREW	2
44	000000-00	No Longer Available	1
45	000000-00	No Longer Available	1
48	422170720001	PLATE	1
50	901064502250	DRIVE SCREW	1
54	901040900112	SET SCREW	2
55	438020110001	HOLDER	2
56	438020070001	BRUSH ASSY	2
57	803250	CAP	2
58	000000-00	No Longer Available	1
60	901250302027	SCREW	2
61	904020101701	Use 904-02-010-1726	2
62	904010101610	STEEL WASHER	2
63	901020100501	MACHINE SCREW	2
64	491957-00	LOCK WASHER	2
65	904010101614	STEEL WASHER	2
68	422170430002	Use 422-17-043-0003	1

COPYRIGHT© 2005. All Rights Reserved.

Parts list, pricing, and availability subject to change. Please visit www.dewaltservicenet.com for current parts information.

Parts List for 34-010 Type 1 S/N FD-6575 & ABOVE

Item Number	Part Number	Description	Qty Required
69	901020100513	MACHINE SCREW	4
70	904010101614	STEEL WASHER	4
71	422170910001	TABLE	1
72	904080213886	WASHER	4
73	901020100558	MACHINE SCREW	3
75	422171120004	LEVEL SCR	1
78	000000-00	No Longer Available	1
79	902010201226	NUT	2
83	491958-00	LOCK WASHER	1
84	901061217383	SCREW	1
85	000000-00	No Longer Available	1
86	1086728	SHAFT	1
87	905010105091	PIN	1
88	904020101703	LOCK WASHER	3
89	901010600602	CAP SCREW	3
91	1088247	Use 422-17-371-0002	1
93	904010101622	STEEL WASHER	1
94	901020100576	MACHINE SCREW	1
95	438010040015	CABLE CLAMP 5/16	1
96	000000-00	No Longer Available	1
97	902010205435	JAM NUT	1
99	1086735	Use 422-17-389-0010	1
100	904010101622	STEEL WASHER	1
101	000000-00	No Longer Available	1
102	902010201226	NUT	2
103	901041501185	SET SCREW	1
104	905050402106	COTTER PIN	1

COPYRIGHT© 2005. All Rights Reserved.

Parts list, pricing, and availability subject to change. Please visit www.dewaltservicenet.com for current parts information.

Parts List for 34-010 Type 1 S/N FD-6575 & ABOVE

Item Number	Part Number	Description	Qty Required
105	1086730	Use 422-17-102-0001	1
106	1086733	SLIDE	1
108	1086731	SPRING	1
109	1086727	RETAINER	1
110	1086724	Use 422-17-112-0005	1
111	901020100558	MACHINE SCREW	1
112	1086725	POINTER	1
113	000000-00	No Longer Available	1
114	1087658	SCREW	1
115	921010100033	BALL	1
116	1087235	SPRING	1
117	1086729	HOUSING	1
118	904010101620	WASHER	2
119	901010600608	CAP SCREW	2

COPYRIGHT© 2005. All Rights Reserved.

Parts list, pricing, and availability subject to change. Please visit www.dewaltservicenetwork.com for current parts information.