

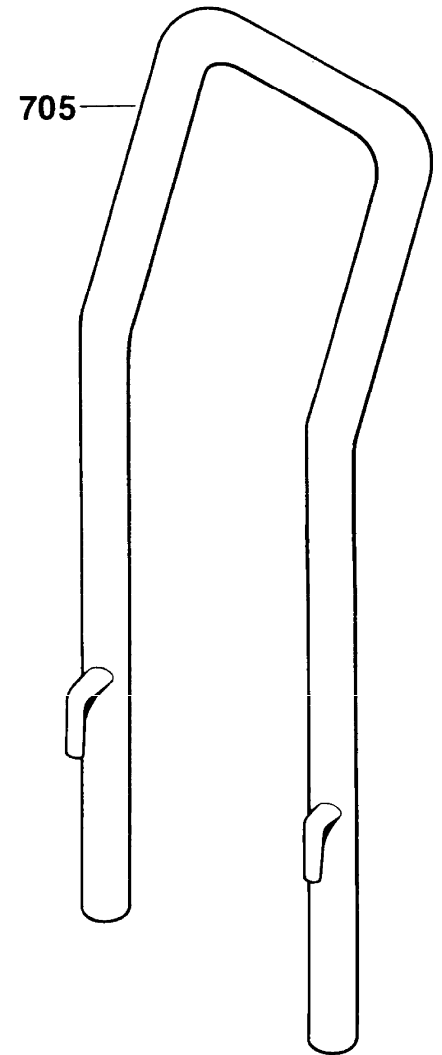

# Typ 0 601 971 0... = GAS 900 RF

Stand ~~89-09~~

Issue 95-01

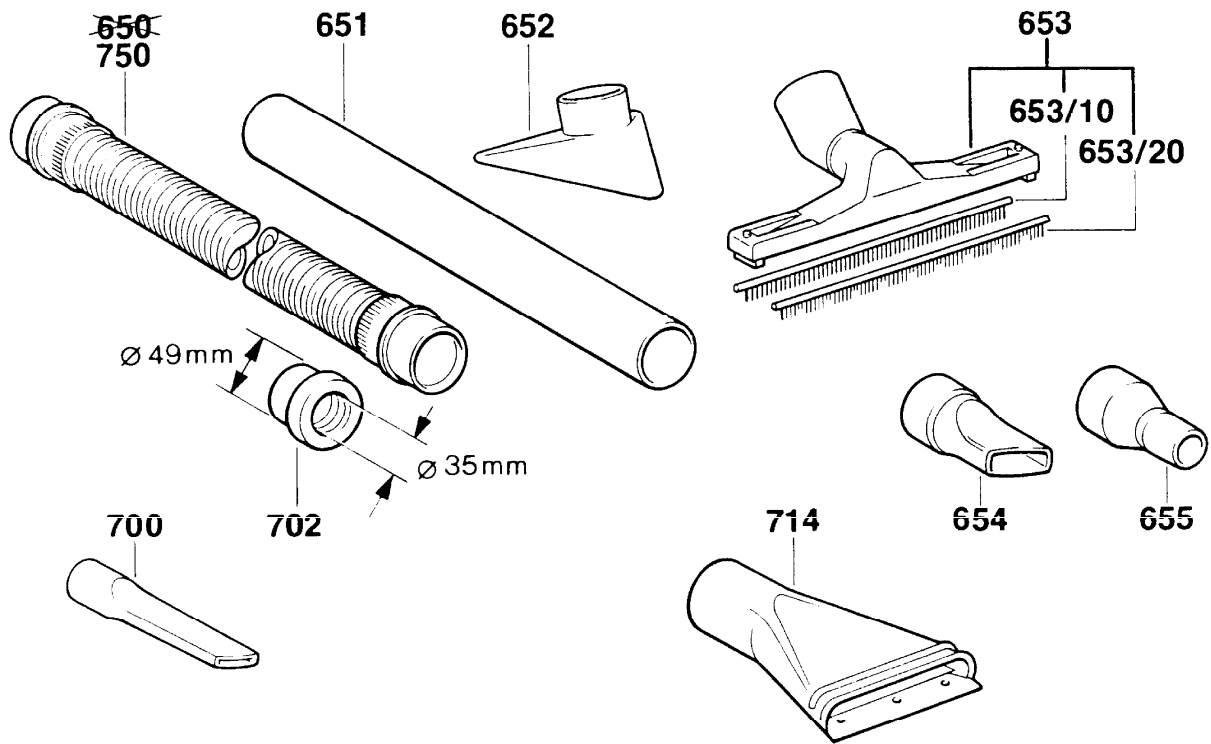

Änderungen vorbehalten

Modifications reserved

Modifications reserves

Salvo modificaciones

Robert Bosch GmbH

Geschäftsbereich Elektrowerkzeuge

70745 Leinfelden-Echterdingen

# Typ 0 601 971 0.. = GAS 900 RF

Stand ~~89-09~~  
Issue 95-01

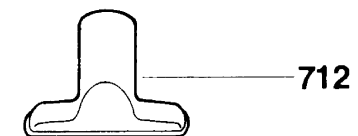
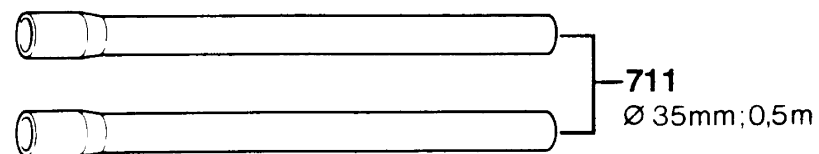
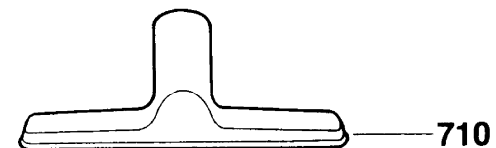
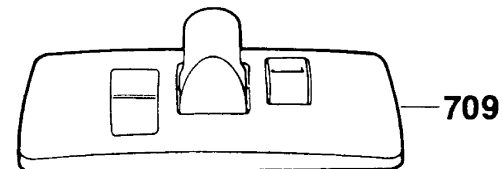
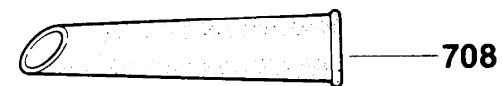
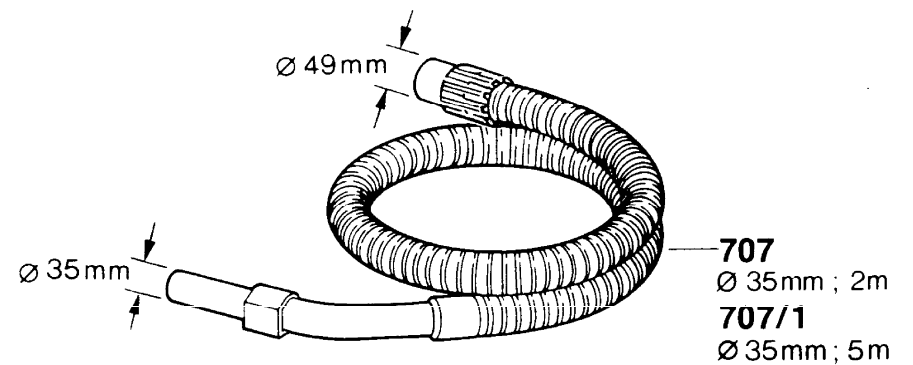

Änderungen vorbehalten  
Modifications reserved  
Modificaciones reserves  
Salvo modificaciones  
Robert Bosch GmbH  
Geschäftsbereich Elektrowerkzeuge  
70745 Leinfelden-Echterdingen